

### 2009 VW Passat CC 2.0L

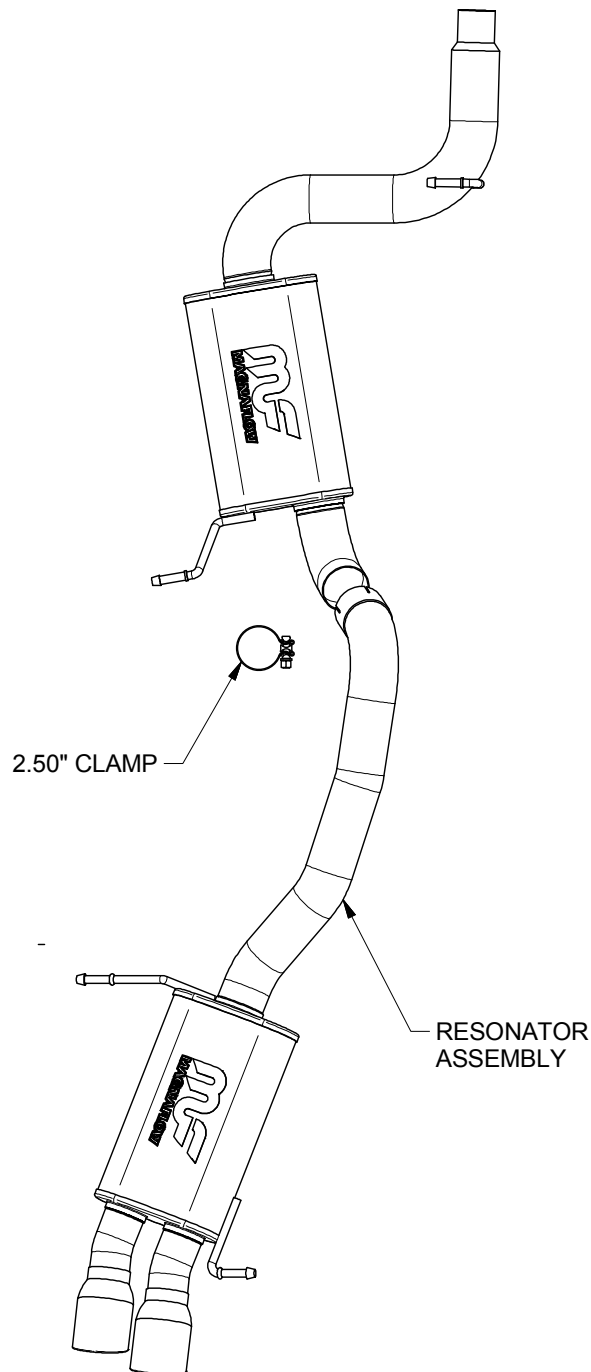

**Warning:** When working on, under, or around any vehicle exercise caution. Please allow the vehicle's exhaust system to cool before removal, as exhaust system temperatures may cause severe burns. If working without a lift, always consult vehicle manual for correct lifting specifications. Always wear safety glasses and ensure a safe work area. Serious injury or death could occur if safety measures are not followed.

**Step 1:** (Carefully read all instructions before installation) Begin by cutting the OEM piping just in front of the rear axle, between the two mufflers. Disengage the hangers from the rubber insulators and remove the rear muffler. Do not damage or discard the OEM fasteners or rubber insulators as they will be reused to mount the new system. Remove the OEM resonator assembly by unbolting the clamp after the catalytic converter, and disengaging the hangers as before.

**Step 2:** Begin installing the new system by fastening the front resonator assembly to the catalytic converter outlet pipe using the OEM clamp. Leave all clamps and fasteners loose for final adjustment of the complete system. Install the muffler assembly by fastening it with the supplied 2.50" clamp and fitting the welded hanger into the rubber insulator.

**Step 3:** With all components mounted loosely, adjust the system for overall aesthetics and clearance of frame & bodywork. (MAGNAFLOW recommends at least 1/2" of clearance between the exhaust system and any body panels to prevent heat-related body damage or fire.)

**Step 4:** Once a final position has been chosen for the new system, evenly tighten all fasteners from front to rear. The supplied band clamps must be VERY tight to properly align the pipes and prevent leaks (approximately 40ft. lbs.). Inspect all fasteners after 25-50 miles of operation and retighten if necessary.

**\*\* Magnaflow Performance Exhaust recommends professional installation on all their products**